

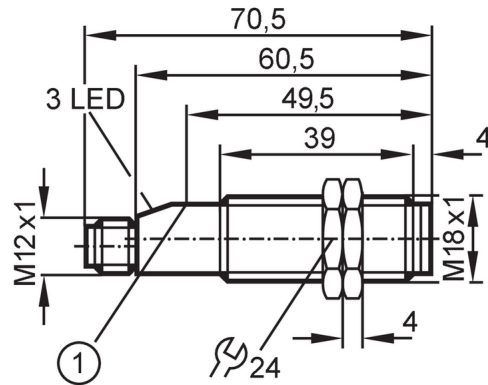

Diffuse reflection sensor with background suppression

OGH-FPKG/US-100



1 pushbutton



Product characteristics

Type of light	red light
Housing	threaded type

Application

Special feature	Gold-plated contacts; Background suppression
Function principle	Diffuse reflection sensor
Application	Industrial applications / factory automation

Electrical data

Operating voltage	[V]	10...30 DC
Current consumption	[mA]	< 60
Protection class		II
Reverse polarity protection		yes
Type of light		red light
Wave length	[nm]	660

Outputs

Electrical design		PNP
Output function		light-on/dark-on mode; (programmable)
Max. voltage drop switching output DC	[V]	2.5
Permanent current rating of switching output DC	[mA]	200
Short-time current rating of switching output	[mA]	200
Switching frequency DC	[Hz]	250
Short-circuit protection		yes
Type of short-circuit protection		pulsed
Overload protection		yes

Detection zone

Range	[mm]	30...130; (white paper 200 x 200 mm 90% remission)
Factory setting		Range: 40 mm

OG5121



Diffuse reflection sensor with background suppression

OGH-FPKG/US-100

Background suppression available	yes
----------------------------------	-----

Operating conditions

Ambient temperature [°C]	-20...60
Protection	IP 67

Tests / approvals

EMC	EN 60947-5-2	
	EN 55011	class B
MTTF [years]		521
UL approval	Ta	< 40 °C
	Enclosure type	Type 1
	voltage supply	Limited Voltage/Current
	UL approval no.	E030
	File number UL	E174191

Mechanical data

Weight [g]	33.5
Housing	threaded type
Dimensions [mm]	M18 x 1 / L = 70.5
Thread designation	M18 x 1
Materials	housing: PBT
Lens material	front pane:PMMA

Displays / operating elements

Display	switching status	1 x LED, yellow
	operation	1 x LED, green
	function	1 x LED, red

Accessories

Items supplied	lock nuts: 2
----------------	--------------

Remarks

Pack quantity	1 pcs.
---------------	--------

Electrical connection

Connector: 1 x M12; coding: A; Contacts: 4, gold-plated





Diffuse reflection sensor with background suppression

OGH-FPKG/US-100

Connection



Diagrams and graphs

accuracy graph

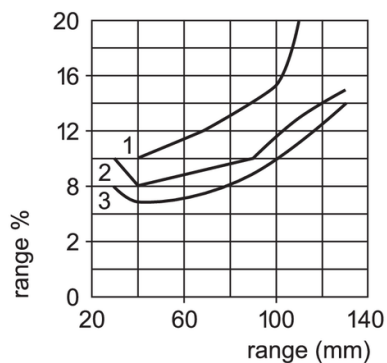

x: distance sensor/object [mm]

y: min. distance object/background [mm]

1 = object black (6 % remission) , background white (90 % remission)

2 = object grey (18 % remission) , background white (90 % remission)

3 = object white (90 % remission) , background white (90 % remission)

Note : range % = setting in % of the range